

VOLÉE SOFT CHAIR Design Angelo Pinaffo



EXCLUSIVE DISTRIBUTION

Designed by the company's R&D department in collaboration with designer Angelo Pinaffo, its key elements are strength and endurance, a performance achieved through the use of a reliable high-density stacking frame. The SOFT versions are based on the use of padded seat and back to feel the utmost comfort while sitting in public spaces.

FINISHES

FRAME

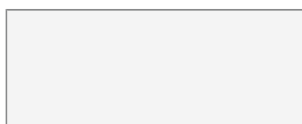

Signal White - RAL 9003

SEAT



ACCESSORIES



Black painted metal trolley, complete of castors

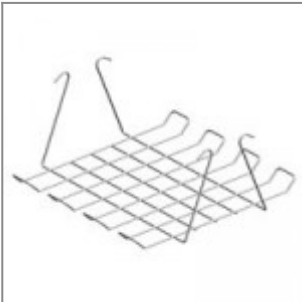

Black metal basket for chair Versa/Flou



Black plastic spacer / linking device for four legged chairs (2 pcs per chair are needed)

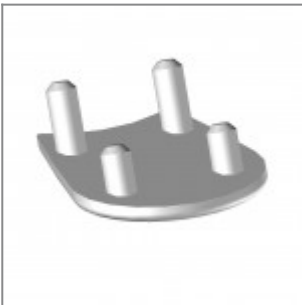

Plastic sliding cap glide for soft and rough surfaces (useful for Flou, laMia and Volée frames)

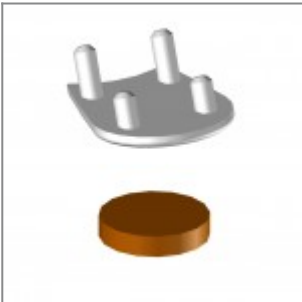

Plastic cap with felt sticker for delicate floor coverings (useful for Flou, laMia and Volée frames)



Chrome metal insert for Volée arm



Aluminium painted metal insert for Volée arm



Black painted metal insert for Volée arm



White painted metal insert for Volée arm



Red plastic arm-pad Volée pantone 201C UV-resistant 300 Klangley



Blue plastic arm-pad Volée pantone 294C UV-resistant 300 Klangley



Grey plastic arm-pad Volée Ral 7040 UV-resistant 300 Klangley



Dark grey plastic arm-pad Volée Ral 7024 UV-resistant 300 Klangley



Black plastic arm-pad Volée UV-resistant 300 Klangley



White Ral 9003 plastic arm-pad Volée UV-resistant 300 Klangley



Black painted male and female linking device for Volée arm chairs (2 simple arms or 1 simple arm + 1 arm with writing tablet)

DIMENSIONS

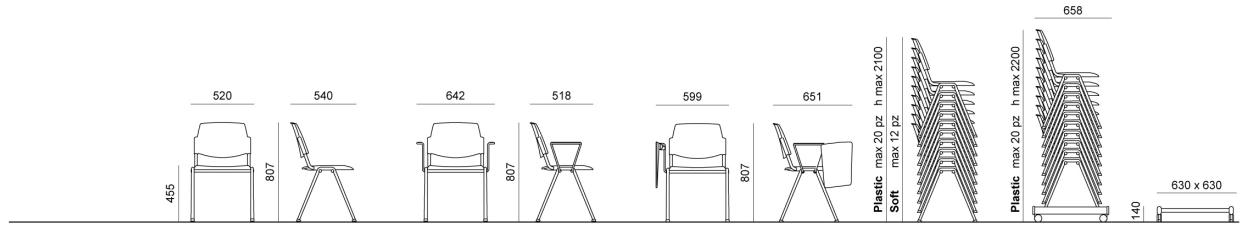

SEDIA CON E SENZA BRACCIOLI E SCRITTOIO | CHAIR WITH OR WITHOUT ARMS AND WRITING TABLET