

VOLÉE NET PLASTIC WRITING TABLET Design Angelo Pinaffo



EXCLUSIVE DISTRIBUTION.

Designed by the company's R&D department in collaboration with designer Angelo Pinaffo, its key elements are strength and endurance, a performance achieved through the use of a reliable high-density stacking frame. VOLÉE NET features a comfortable mesh back, as well as many frame options and accessories, to become the ideal solution for all public spaces.

FINISHES

FRAME



Signal White - RAL 9003

ARMREST



Jet Black - RAL 9005

Signal White - RAL 9003

Window Grey - RAL 7040

BACK



Jet Black - RAL 9005

SEAT



Window Grey - RAL 7040



Signal White - RAL 9003

SUPPORTS



Signal White - RAL 9003



Window Grey - RAL 7040



Jet Black - RAL 9005

ACCESSORIES



Black painted metal trolley, complete of castors

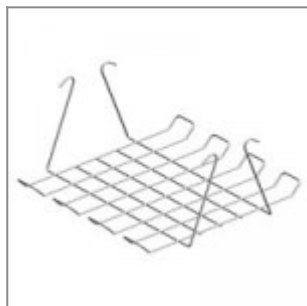

Black metal basket for chair Versa/Flou

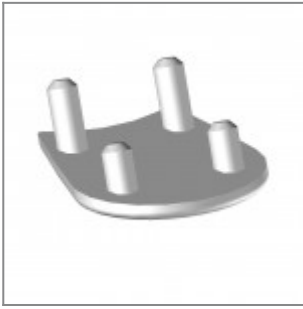

Plastic sliding cap glide for soft and rough surfaces (useful for Flou, laMia and Volée frames)



Plastic cap with felt sticker for delicate floor coverings (useful for Flou, laMia and Volée frames)



Black painted male and female linking device for Volée arm chairs (2 simple arms or 1 simple arm + 1 arm with writing tablet)

DIMENSIONS

VOLÉE PLASTIC | NET PLASTIC | EASY SOFT | SOFT | NET SOFT . Design Angelo Pinaffo

DIEMMEBI®

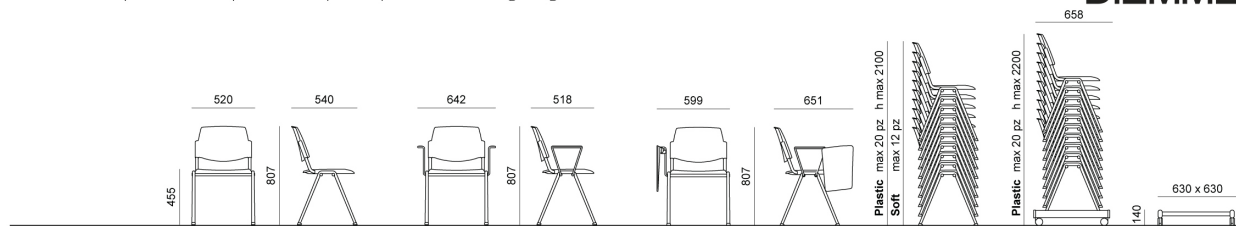

SEDIA CON E SENZA BRACCIOLI E SCRITTOIO | CHAIR WITH OR WITHOUT ARMS AND WRITING TABLET