

## laMIA METAL CHAIR Design Angelo Pinaffo



Family of chairs with epoxy-coated or chrome-plated metal frame. Seat and back made of anti-UV treated injection moulded polypropylene. Also available in the flame retardant and biodegradable version upon request. Upholstery can be added to the plastic seat and back or just to the seat. Wood and metal complete the range. Wide range of accessories available. Ideal for all public spaces that are intensively used.

### ACCESSORIES



Black spacer for chairs, accessories not included



Black painted metal trolley, complete of castors

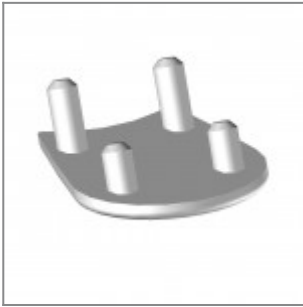

Plastic sliding cap glide for soft and rough surfaces (useful for Flou, laMia and Volée frames)



Plastic cap with felt sticker for delicate floor coverings (useful for Flou, laMia and Volée frames)

## DIMENSIONS

**laMIA** PLASTIC | EASY SOFT | SOFT | WOOD | METAL . Design Angelo Pinaffo

**DIEMMEBI®**

