

MULTI PLASTIC BENCH Design Diemmebi R&D



Family of chairs with epoxy-coated or chromed metal frame. Multi features injection molded polypropylene seat and back. The range also includes the upholstered version to add extra comfort to the chair. Many accessories are available to make Multi an ideal solution for waiting areas, conference rooms and offices.

FINISHES

SEAT



Window Grey - RAL 7040



Signal White - RAL 9003



Jet Black - RAL 9005

BACK



Jet Black - RAL 9005



Signal White - RAL 9003



Window Grey - RAL 7040

ACCESSORIES

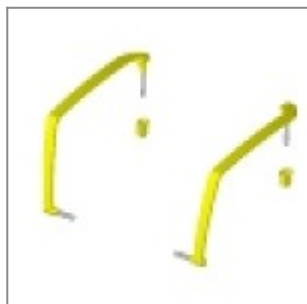

Black plastic pair of Multi arms

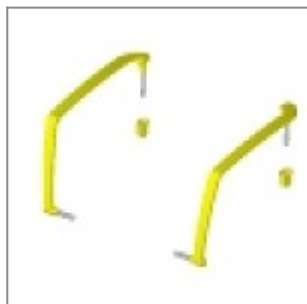

Grey plastic pair of Multi arms

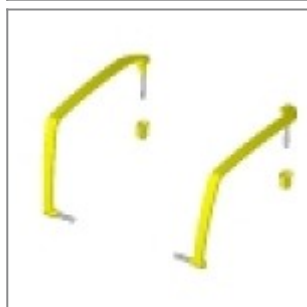

White plastic pair of Multi arms

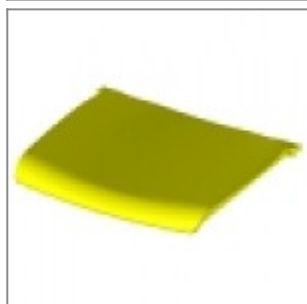

Black fireproof polypropylene seat, not suitable for cantilever frame

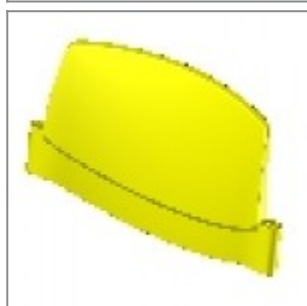

Black fireproof polypropylene Multi back

DIMENSIONS

MULTI PLASTIC | EASY SOFT | SOFT . Design Diemmebi R&D

DIEMMEBI[®]

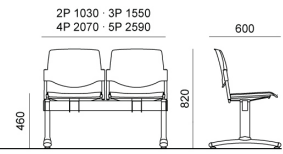

PANCA | *BENCH*

MULTI PLASTIC | EASY SOFT | SOFT . Design Diemmebi R&D

DIEMMEBI[®]

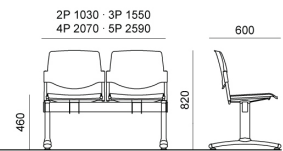

PANCA | *BENCH*