

laMIA PLASTIC CHAIR Design Angelo Pinaffo



Family of chairs with epoxy-coated or chrome-plated metal frame. Seat and back made of anti-UV treated injection moulded polypropylene. Also available in the flame retardant and biodegradable version upon request. Upholstery can be added to the plastic seat and back or just to the seat. Wood and metal complete the range. Wide range of accessories available. Ideal for all public spaces that are intensively used.

FINISHES

BACK



Pantone - Sand



Pantone - 375C



Pantone - 279C



Pantone - 201C



Window Grey - RAL 7040



Jet Black - RAL 9005



Signal White - RAL 9003

SEAT



Pantone - Sand



Pantone - 375C



Pantone - 279C



Pantone - 201C



Window Grey - RAL 7040



Jet Black - RAL 9005



Signal White - RAL 9003

FRAME



Signal White - RAL 9003

ARMREST



Jet Black - RAL 9005

ACCESSORIES



Black spacer for chairs, accessories not included



Black painted metal trolley, complete of castors

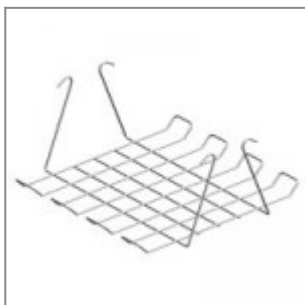

Black metal basket for chair Versa/Flou



Black plastic spacer / linking device for four legged chairs (2 pcs per chair are needed)

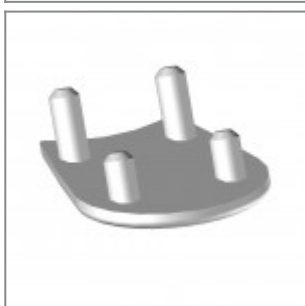

Plastic sliding cap glide for soft and rough surfaces (useful for Flou, laMia and Volée frames)

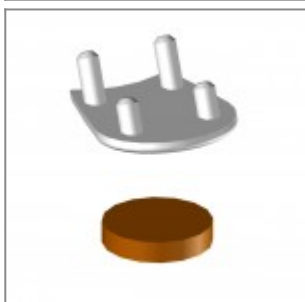

Plastic cap with felt sticker for delicate floor coverings (useful for Flou, laMia and Volée frames)

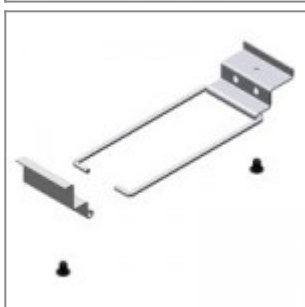

Long metal linking device to link chairs Versa/Flou

DIMENSIONS

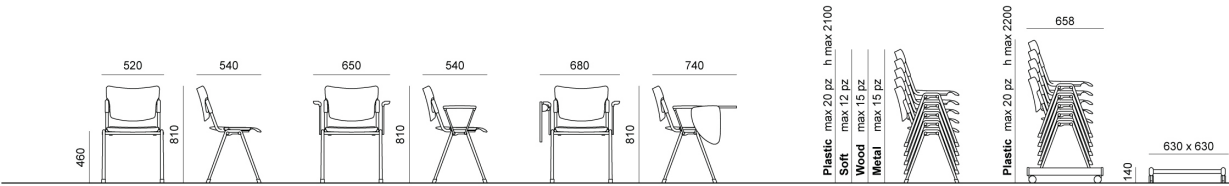

SEDIA CON E SENZA BRACCIOLI E SCRITTOIO | CHAIR WITH OR WITHOUT ARMS AND WRITING TABLET